

N:\Civ\3D Projects\41292\Production Drawings\41292DS17.dwg, 10/29/2019 1:54:44 PM, sandra, 1:2

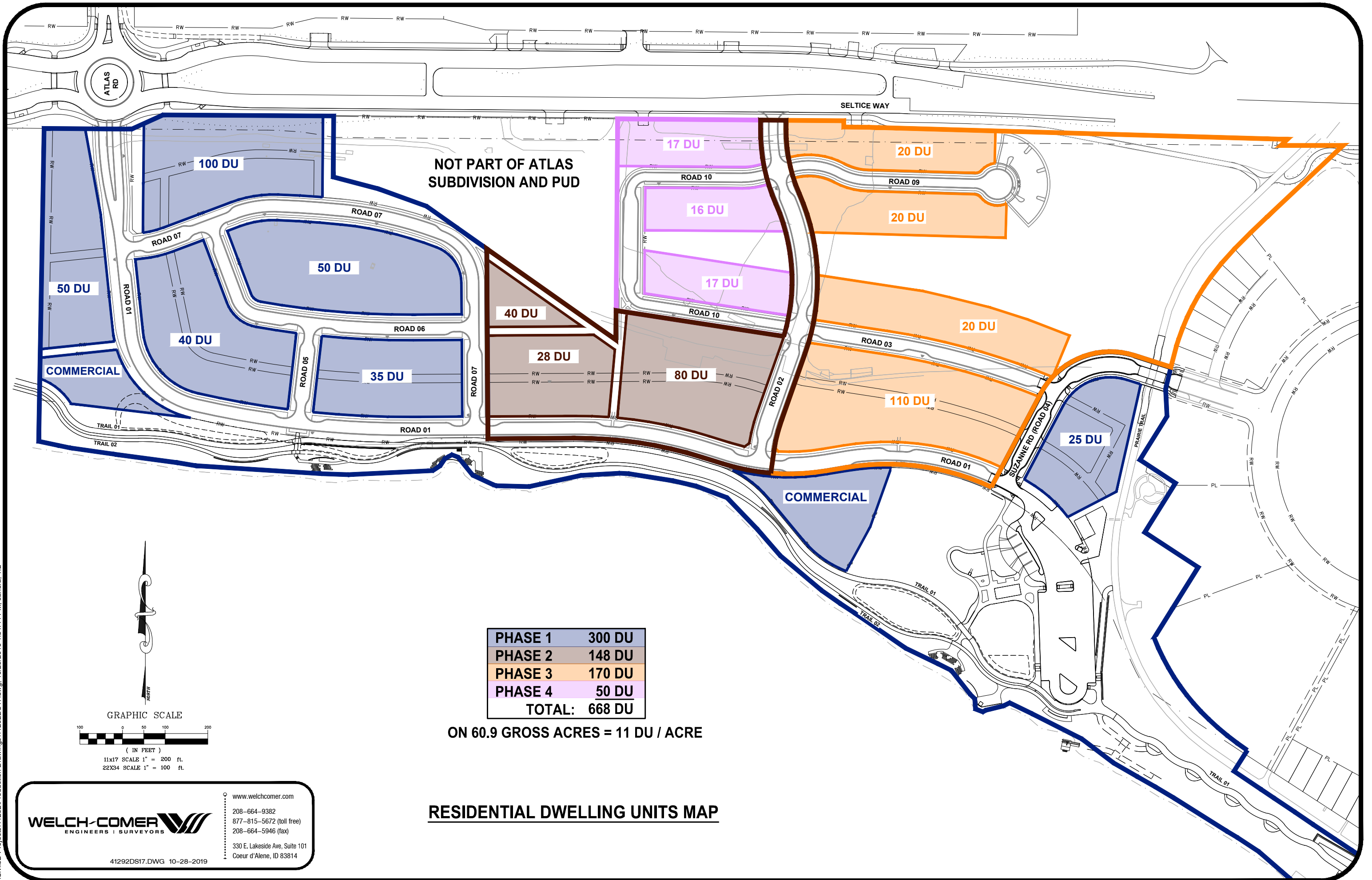

PHASE 1	300 DU
PHASE 2	148 DU
PHASE 3	170 DU
PHASE 4	50 DU
TOTAL:	668 DU

ON 60.9 GROSS ACRES = 11 DU / ACRE

RESIDENTIAL DWELLING UNITS MAP



www.welchcomer.com
 208-664-9382
 877-815-5672 (toll free)
 208-664-5946 (fax)
 330 E. Lakeside Ave, Suite 101
 Coeur d'Alene, ID 83814

41292DS17.DWG 10-28-2019